

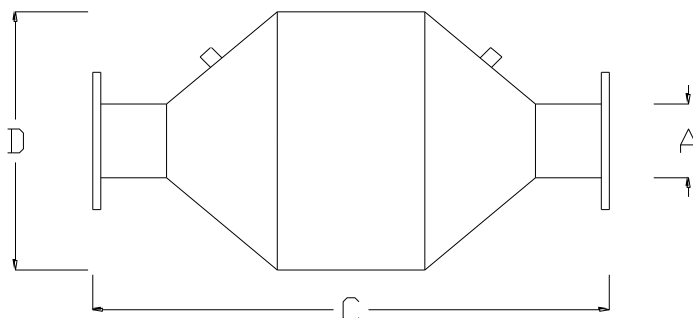

Catalytic Converter



CEC (Cord Exhaust Catalyst)

(Flange End or Slot End)

Model	A	C	ØD
CEC 4	To Advise	240	80
CEC 5	To Advise	300	100
CEC 6	To Advise	350	125
CEC 7	To Advise	360	150
CEC 8	To Advise	390	175
CEC 9	To Advise	460	195
CEC 10	To Advise	540	215
CEC 11	To Advise	540	235

*Other sizes available upon request

CONSTRUCTION:

The purifier housing is constructed from heavy gauge, high T304 stainless steel for corrosion resistance and long life. The catalyst substrate is also constructed from stainless steel and formed into a honeycomb like structure. The robust construction of the housing and catalyst substrate protects the unit against vibration, thermal stress and shock impacts which are associated with urban transport equipment.

PERFORMANCE FOR CATALYTIC CONVERTER:

This is a single-layered Purifier and can achieve maximum oxidation of black smoke under optimum temperature, as specified in the Productivity Standard Board (Singapore) Test Report Ref. No.: 2599209 dated September 1999, basing on British Standards 3405 (1983) and TÜV SÜD PSB Test Report Ref. No.: 7191145306-CHM16-YL dated September 2016.

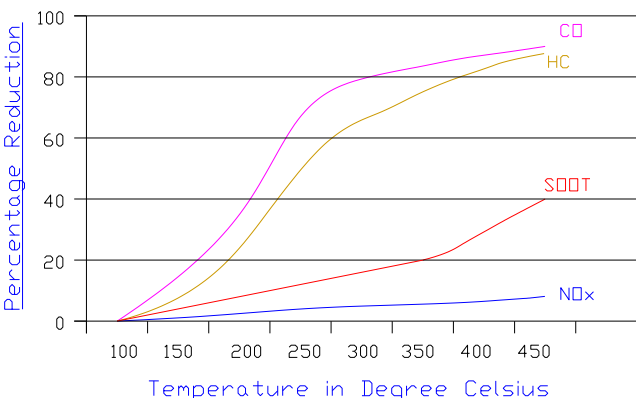

PERFORMANCE (BASED ON FULL LOAD):

Carbon Monoxide	*reduced by up to 90%
Hydrocarbons	*reduced by up to 90%
Particulates	*reduced by up to 25-30%
Soluble Organic Fraction	*reduced by up to 85%

* Under optimal thermal and operating conditions.

CHEMICAL REACTION:

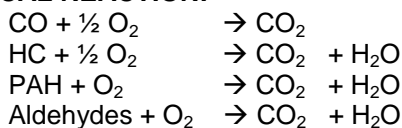

A coated catalyst block is expected to perform for 5 years or more. It is self-regenerating or cleaning when the engine is operating at an exhaust gas temperature of 360°C and above for a few hours continuously.

CORD EXHAUST ENGINEERING PTE LTD

69 TECH PARK CRESCENT, SINGAPORE 638073.

TEL NO : +65 6744 2689 FAX NO : +65 6747 2217 E-MAIL : enquires@cordexhaust.com.sg WEBSITE : www.cordexhaust.com.sg